

NOTES

- 1) ALL DIMENSIONS ARE IN MM.
- 2) ALL EXTERNAL WALLS ARE 200 THK
- 3) ALL PARTITIONS WALLS ARE 125 THK UNLESS OTHERWISE MENTIONED.

DECLARATION OF ARCHITECT

CERTIFIED WITH FULL RESPONSIBILITY THAT THE BUILDING PLAN HAS BEEN DRAWN UP AS PER PROVISION OF K.M.C. BUILDING RULES 2009 AS AMENDED FROM TIME TO TIME AND THAT THE SITE CONDITIONS INCLUDING THE WIDTH OF THE ABUTTING ROAD VERIFIED WITH THE PLAN AND WHICH HAS BEEN MEASURED AND IT IS A BUILDABLE SITE AND NOT A TANK OR FILLED UP TANK.

DECLARATION OF STRUCTURAL ENGINEER.
THE STRUCTURAL DESIGN AND DRAWING OF BOTH FOUNDATION AND SUPERSTRUCTURE OF THE BUILDING HAS BEEN MADE BY ME CONSIDERING THE NATIONAL BUILDING CODE OF INDIA AND CERTIFIED THAT IT IS SAFE AND STABLE IN ALL RESPECTS. SOIL TEST HAS BEEN DONE BY ALOK ROY, 6A, MILAN PARK, KOLKATA. THE RECOMMENDATION OF SOIL TEST REPORT HAS BEEN CONSIDERED DURING STRUCTURAL CALCULATIONS.

SIGNATURE OF ARCHITECT.
(Signature)
SANTIV J. PAREKH
M.E. (STRUCTURAL) & CONST. ENGRG.
E.S.E. NO. 104 (U) K.M.C.

SIGNATURE OF ARCHITECT.
(Signature)
SANTIV J. PAREKH
M.E. (STRUCTURAL) & CONST. ENGRG.
E.S.E. NO. 104 (U) K.M.C.

SIGNATURE OF ARCHITECT.
(Signature)
SANTIV J. PAREKH
M.E. (STRUCTURAL) & CONST. ENGRG.
E.S.E. NO. 104 (U) K.M.C.

SIGNATURE OF ARCHITECT.
(Signature)
SANTIV J. PAREKH
M.E. (STRUCTURAL) & CONST. ENGRG.
E.S.E. NO. 104 (U) K.M.C.

SIGNATURE OF ARCHITECT.
(Signature)
SANTIV J. PAREKH
M.E. (STRUCTURAL) & CONST. ENGRG.
E.S.E. NO. 104 (U) K.M.C.

SIGNATURE OF ARCHITECT.
(Signature)
SANTIV J. PAREKH
M.E. (STRUCTURAL) & CONST. ENGRG.
E.S.E. NO. 104 (U) K.M.C.

SIGNATURE OF ARCHITECT.
(Signature)
SANTIV J. PAREKH
M.E. (STRUCTURAL) & CONST. ENGRG.
E.S.E. NO. 104 (U) K.M.C.

SIGNATURE OF ARCHITECT.
(Signature)
SANTIV J. PAREKH
M.E. (STRUCTURAL) & CONST. ENGRG.
E.S.E. NO. 104 (U) K.M.C.

SIGNATURE OF ARCHITECT.
(Signature)
SANTIV J. PAREKH
M.E. (STRUCTURAL) & CONST. ENGRG.
E.S.E. NO. 104 (U) K.M.C.

SIGNATURE OF ARCHITECT.
(Signature)
SANTIV J. PAREKH
M.E. (STRUCTURAL) & CONST. ENGRG.
E.S.E. NO. 104 (U) K.M.C.

SIGNATURE OF ARCHITECT.
(Signature)
SANTIV J. PAREKH
M.E. (STRUCTURAL) & CONST. ENGRG.
E.S.E. NO. 104 (U) K.M.C.

SIGNATURE OF ARCHITECT.
(Signature)
SANTIV J. PAREKH
M.E. (STRUCTURAL) & CONST. ENGRG.
E.S.E. NO. 104 (U) K.M.C.

DOORS AND WINDOWS SCHEDULE

DOORS		WINDOWS	
MKD.	WIDTH	MKD.	WIDTH
D1	1200	W1	3000
D2	1000	W2	2400
D3	900	W3	1800
D4	800	W4	1500
D5	750	W5	900
FCD	1000	W6	600
SD1	4000	W7	1200
SD2	2500	W8	2200
SD3	2500	W9	2200
D/W	800 / 800	W10	2400 / 1400

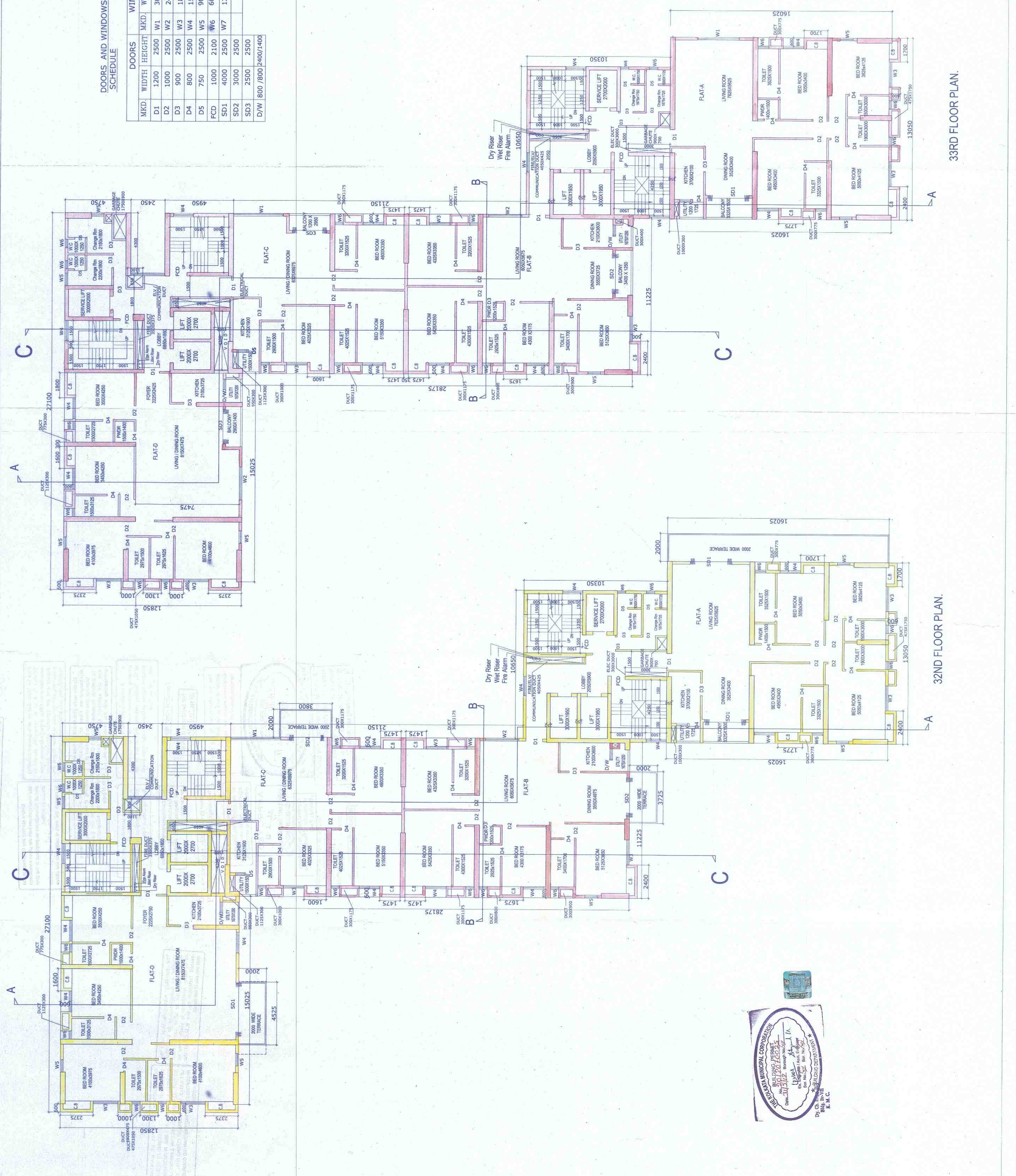

32ND FLOOR PLAN.

33RD FLOOR PLAN.



D. CH. BHATT
B.L. BHATT
K.M.C.

ARCHITECTS :
THE DESIGN CELL
2A COOPER STREET,
KOLKATA-700026
SHEET TITLE :- 32ND & 33RD
FLOOR PLANS
SHEET NO. - ARCHY/CORP/08
Date :- 19/07/18
Scale :- 1:100

DECLARATION OF OWNERS
I DO HEREBY DECLARE WITH FULL RESPONSIBILITY THAT I SHALL ENGAGE ARCHITECT & E.S.E. DURING CONSTRUCTION. I SHALL FOLLOW THE INSTRUCTIONS OF ARCHITECT & E.S.E. DURING CONSTRUCTION. I SHALL NOT BE RESPONSIBLE FOR STRUCTURAL STABILITY OF THE BUILDING AND ADJOINING STRUCTURE IF ANY SUBMITTED DOCUMENTS ARE FOUND TO BE FAKE. THE K.M.C. AUTHORITY WILL REVOKE THE SANCTION PLAN. THE CONSTRUCTION OF WATER TOWER AND SEPTIC TANK WILL BE UNDERTAKEN UNDER THE GUIDANCE OF E.S.E. THE FOUNDATION WORK, PLOT IS IDENTIFIED BY ME DURING INSPECTION.

DECLARATION OF OWNERS
I DO HEREBY DECLARE WITH FULL RESPONSIBILITY THAT I SHALL ENGAGE ARCHITECT & E.S.E. DURING CONSTRUCTION. I SHALL FOLLOW THE INSTRUCTIONS OF ARCHITECT & E.S.E. DURING CONSTRUCTION. I SHALL NOT BE RESPONSIBLE FOR STRUCTURAL STABILITY OF THE BUILDING AND ADJOINING STRUCTURE IF ANY SUBMITTED DOCUMENTS ARE FOUND TO BE FAKE. THE K.M.C. AUTHORITY WILL REVOKE THE SANCTION PLAN. THE CONSTRUCTION OF WATER TOWER AND SEPTIC TANK WILL BE UNDERTAKEN UNDER THE GUIDANCE OF E.S.E. THE FOUNDATION WORK, PLOT IS IDENTIFIED BY ME DURING INSPECTION.

DECLARATION OF OWNERS
I DO HEREBY DECLARE WITH FULL RESPONSIBILITY THAT I SHALL ENGAGE ARCHITECT & E.S.E. DURING CONSTRUCTION. I SHALL FOLLOW THE INSTRUCTIONS OF ARCHITECT & E.S.E. DURING CONSTRUCTION. I SHALL NOT BE RESPONSIBLE FOR STRUCTURAL STABILITY OF THE BUILDING AND ADJOINING STRUCTURE IF ANY SUBMITTED DOCUMENTS ARE FOUND TO BE FAKE. THE K.M.C. AUTHORITY WILL REVOKE THE SANCTION PLAN. THE CONSTRUCTION OF WATER TOWER AND SEPTIC TANK WILL BE UNDERTAKEN UNDER THE GUIDANCE OF E.S.E. THE FOUNDATION WORK, PLOT IS IDENTIFIED BY ME DURING INSPECTION.

DECLARATION OF OWNERS
I DO HEREBY DECLARE WITH FULL RESPONSIBILITY THAT I SHALL ENGAGE ARCHITECT & E.S.E. DURING CONSTRUCTION. I SHALL FOLLOW THE INSTRUCTIONS OF ARCHITECT & E.S.E. DURING CONSTRUCTION. I SHALL NOT BE RESPONSIBLE FOR STRUCTURAL STABILITY OF THE BUILDING AND ADJOINING STRUCTURE IF ANY SUBMITTED DOCUMENTS ARE FOUND TO BE FAKE. THE K.M.C. AUTHORITY WILL REVOKE THE SANCTION PLAN. THE CONSTRUCTION OF WATER TOWER AND SEPTIC TANK WILL BE UNDERTAKEN UNDER THE GUIDANCE OF E.S.E. THE FOUNDATION WORK, PLOT IS IDENTIFIED BY ME DURING INSPECTION.

DECLARATION OF OWNERS
I DO HEREBY DECLARE WITH FULL RESPONSIBILITY THAT I SHALL ENGAGE ARCHITECT & E.S.E. DURING CONSTRUCTION. I SHALL FOLLOW THE INSTRUCTIONS OF ARCHITECT & E.S.E. DURING CONSTRUCTION. I SHALL NOT BE RESPONSIBLE FOR STRUCTURAL STABILITY OF THE BUILDING AND ADJOINING STRUCTURE IF ANY SUBMITTED DOCUMENTS ARE FOUND TO BE FAKE. THE K.M.C. AUTHORITY WILL REVOKE THE SANCTION PLAN. THE CONSTRUCTION OF WATER TOWER AND SEPTIC TANK WILL BE UNDERTAKEN UNDER THE GUIDANCE OF E.S.E. THE FOUNDATION WORK, PLOT IS IDENTIFIED BY ME DURING INSPECTION.

DECLARATION OF OWNERS
I DO HEREBY DECLARE WITH FULL RESPONSIBILITY THAT I SHALL ENGAGE ARCHITECT & E.S.E. DURING CONSTRUCTION. I SHALL FOLLOW THE INSTRUCTIONS OF ARCHITECT & E.S.E. DURING CONSTRUCTION. I SHALL NOT BE RESPONSIBLE FOR STRUCTURAL STABILITY OF THE BUILDING AND ADJOINING STRUCTURE IF ANY SUBMITTED DOCUMENTS ARE FOUND TO BE FAKE. THE K.M.C. AUTHORITY WILL REVOKE THE SANCTION PLAN. THE CONSTRUCTION OF WATER TOWER AND SEPTIC TANK WILL BE UNDERTAKEN UNDER THE GUIDANCE OF E.S.E. THE FOUNDATION WORK, PLOT IS IDENTIFIED BY ME DURING INSPECTION.

DECLARATION OF OWNERS
I DO HEREBY DECLARE WITH FULL RESPONSIBILITY THAT I SHALL ENGAGE ARCHITECT & E.S.E. DURING CONSTRUCTION. I SHALL FOLLOW THE INSTRUCTIONS OF ARCHITECT & E.S.E. DURING CONSTRUCTION. I SHALL NOT BE RESPONSIBLE FOR STRUCTURAL STABILITY OF THE BUILDING AND ADJOINING STRUCTURE IF ANY SUBMITTED DOCUMENTS ARE FOUND TO BE FAKE. THE K.M.C. AUTHORITY WILL REVOKE THE SANCTION PLAN. THE CONSTRUCTION OF WATER TOWER AND SEPTIC TANK WILL BE UNDERTAKEN UNDER THE GUIDANCE OF E.S.E. THE FOUNDATION WORK, PLOT IS IDENTIFIED BY ME DURING INSPECTION.

32 ND 33 RD
PARTY'S COPY

Before starting any construction the site must be prepared in accordance with all conditions as proposed in the plan and all conditions as proposed in the plan should be fulfilled.
The validity of the written permission to execute the work is subject to the above conditions.

Plan for Water Supply arrangement including S.E.M.I. G. & O. H. reservoirs should be submitted at the Office of the Ex-Engineer Water Supply and Sanitation before the written permission is issued. Any variation in elevation may lead to disconnection.

No rain water pipe should be laid or discharges from rain water pipes should be made at any place where the Borough Executive Engineer's Office and the sanction obtained before proceeding with the drainage work.

Available rain water to be provided, i.e. pumps, unfiltered water for the distribution to the flushing cisterns and urinals in the building incase unfiltered water from street main is not available.

SEWAGE TREATMENT PLANT
THE SANCTION IS VALID UP TO 30/06/2024

The sanction refers to the proposed portion shown in red and the Executive Engineer makes no admission as to the correctness of the plan.

PROVISION FOR USE OF SOLAR ENERGY IN THE FORM OF SOLAR HEATER AND / OR SOLAR PHOTO-VOLTAIC SHALL BE PROVIDED AS PER RULE 147 OF BUILDING RULES, 2008 AND COMPLETE PHOTO-VOLTAIC PANELS WILL NOT BE ISSUED IN CASE OF BUILDING WITHOUT SOLAR PROVISION



All Building Materials to necessary for the construction should be as per standards specified in the National Building Code of India.

Not Commencement of Erection or Re-Erection within Two Year will Require Fresh Application for Sanction.

Approved By: *[Signature]* M.C.C. No. 534 dt 24/6/24
The Building Committee

Necessary stops should be taken for the safety of the lives of the public and private property during construction.

APPROVED
[Signature]
ASSISTANT ENGINEER (S)
BOROUGH NO. 17
Approved subject to Compliance of conditions as set forth in the Services, N. City.
OFFICE OF THE CORPORATION ENGINEER
BUILDING DEPARTMENT
M.C.C. NO. 534
THE COCHIN MUNICIPAL CORPORATION
RESIDENTIAL BUILDING

CONSTRUCTION SITE SHALL BE MAINTAINED TO PREVENT MOSQUITO BREEDING AS REQUIRED UNDER (1) & (2) OF CHC ACT 1986 IN SUCH MANNER SO THAT ALL WATER COLLECTING SURFACES OPEN UPON THE CONSTRUCTION SITE, MUST BE EMPTIED COMPLETELY TWICE A WEEK.

The building materials that will be stacked 3 months or after construction should be stored on the floor, whichever is the lower, at the cost and risk of the owner.